

## SERIE 23

**Rectangular Exterior Doors P23-201**

References: P23-201 / P23-202 / P23-203 / P23-204

**Finitions :**

ON STEEL OR CARBON :

- ⊗ Manufacturing crude without coating

ON STAINLESS STEEL :

- ⊗ BURNISHING: Rolled sheets and flats, presence of tool marks, unstripped welds.
- ⊗ MICROBLES: Satin matte appearance.
- ⊗ ELECTROPOLISHING WITH Ra (μ): on request from < 1.6 to > 0.4.

STANDARDS AND SPECIFICATIONS :

**Frame :**

- ⊗ Hot rolled plate in stainless steel 1.4301 / 1.4307 or 1.4404, height 60 mm, thickness 8 mm, usable passage with tolerance of +/- 2 mm.
- ⊗ Standard finish : Polishing grain 50.

**Wicket door :**

- ⊗ Sheet 2B 2 mm stainless steel 1.4301 / 1.4307 and 1.4404, electropolished.

**Component parts :**

- ⊗ Stainless steel 1.4301 or 1.4307.
- ⊗ Stainless steel handwheel or lever in 1.4401, 1.4404, 1.4305, 1.4301 or 1.4307 with or without bronze insert according to model to be seen with the sales department.

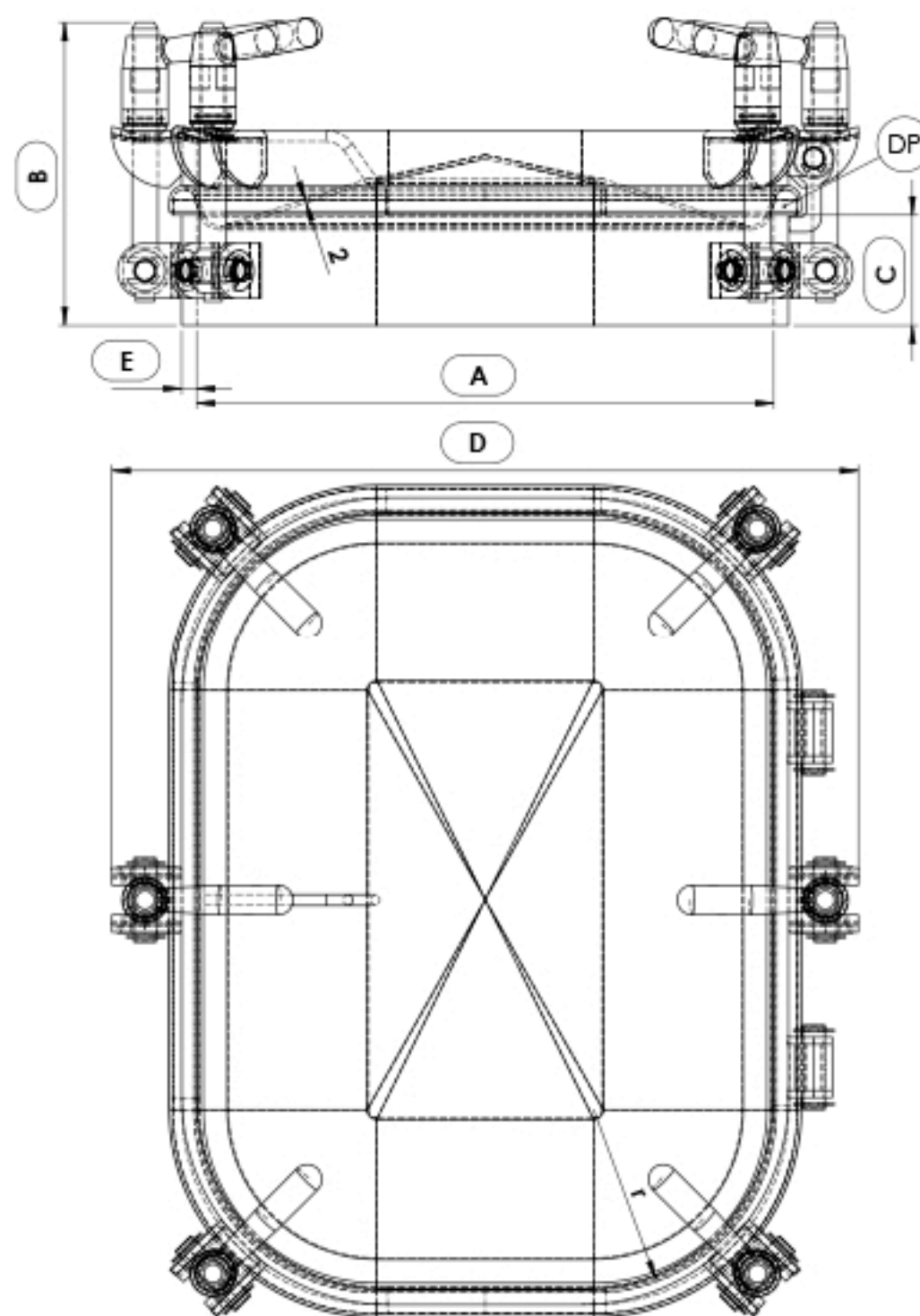
**Technical specifications**

	DN Size	Frame			Space requirement		Number of clamps	Unit Weight in kg	CALCULATION PRESSURE (non FEP gasket) CODAP IN BAR at 150° (To be limited according to the gasket material used)			Pmax Maximum operating pressure at room temperature (Bar) non-FEP seal. Door not submitted.	Vacuum Vacuum pressure Absolute value in BAR (non-FEP seal)	Joints
		A	C	E	B	D Dim hors tout			Operating pressure 150°C	Test pressure 20°C	ASME 2007 in BAR at 150° without the 'u' stamp			
P23-201	314x424	60	8	155	402	6	13	NA	NA	NA	1,6	0,2	sticked	
P23-202	424x314	60	8	155	480	6	13	NA	NA	NA	1,6	0,2	sticked	
P23-203	410x534	60	8	155	498	6	18	NA	NA	NA	1,2	0,1	sticked	
P23-204	534x410	60	8	155	590	6	18	NA	NA	NA	1,2	0,1	sticked	