

Sight glass - Tubular type

with flanged connection acc. to DIN

NORIS

Bauform 20

Application:

Sight glass - Tubular type with flanges on both sides to use in either horizontal or vertical pipe lines for optical control of fluids and gasses.

Operating conditions:

Connection: Flanges PN 10 / 16
 Pressure: up to DN 100 - 6 bar max
 DN 125 and up – 4 bar max
 Temperature: 200°C max.

Installation:

Optional

Special designs:

Protection jacket of acrylic glass
 ANSI - Flanges
 Extra length

Materials:

Flanges	WN 1.4571	Steel H II
Screws	A4 - 70	Steel
Glass tube	Borosilicate glass	
Gaskets	Viton (PTFE or other materials)	

Ordering example:

Sight Glass - Tubular Type Bauform 20
 WN 1.4571, Gaskets Viton
 max. 6 bar / 200°C
 DN 50, PN 10

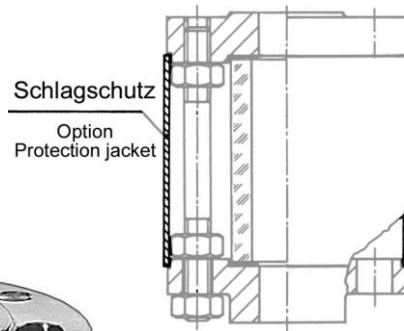
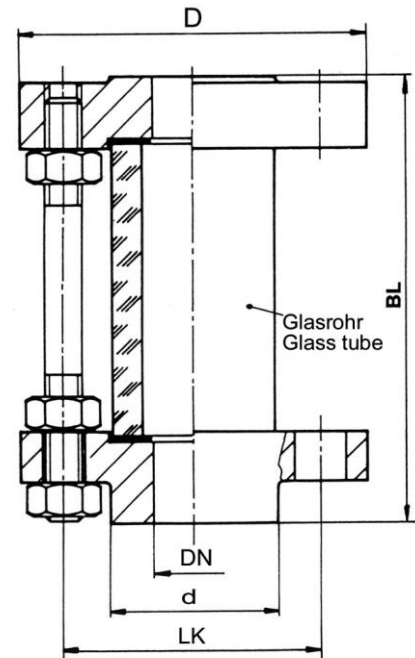
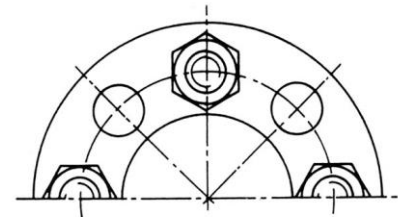

Dimensions:

DN	D	d	BL	Screws	LK
15	95	45	200	4	65
20	105	58	200	4	75
25	115	68	200	4	85
32	140	78	200	4	100
40	150	88	200	4	110
50	165	102	200	4	125
65	185	122	200	4	145
80	200	138	200	4	160
100	220	158	200	4	180
125	250	188	200	8	210
150	285	212	200	8	240
200	340	268	200	8	295

Mounting instructions:

Sight glass tubular type must be mounted without tension by tube, vibrations and pressure pushes.

Modification reserved

Sight glass - Tubular type

with flanged connection acc. to ANSI 150 lbs

NORIS

Bauform 20-A

Application:

Sight glass - Tubular type with flanges on both sides to use in either horizontal or vertical pipe lines for optical control of fluids and gasses.

Operating conditions:

Connection: ANSI-Flanges 150 lbs-RF
 Pressure: up to DN 100 - 6 bar max
 DN 125 and up – 4 bar max
 Temperature: 200°C max.

Installation:

Optional

Special designs:

Protection jacket of acrylic glass
 Extra length

Materials:

Flanges	WN 1.4571	Steel / H II
Screws	A4 - 70	Steel
Glass tube	Borosilicate glass (DURAN)	
Gaskets	Viton or PTFE (or other materials)	

Ordering example:

Sight Glass - Tubular Type Bauform 20
 WN 1.4571;
 Max. 6 bar / 200°C
 ANSI 2", 150 lbs

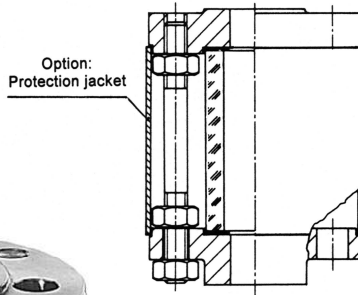
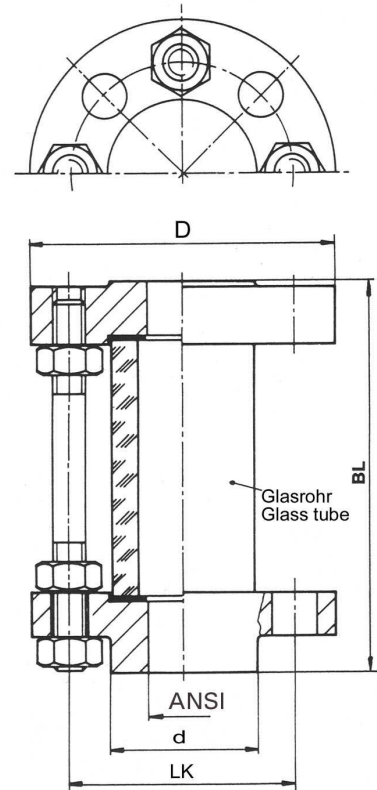

Dimensions:

ANSI	D	d	BL	Screws	LK
1/2"	89	35	200	4	60,3
3/4"	98	43	200	4	69,8
1"	108	51	200	4	79,4
1 1/4"	118	64	200	4	88,9
1 1/2"	127	73	200	4	98,4
2"	152	92	200	4	120,6
2 1/2"	178	105	200	4	139,7
3"	191	127	200	4	152,4
4"	228	157	200	4	190,6
5"	254	186	200	8	215,9
6"	279	216	200	8	241,3
8"	343	270	200	8	298,4

Mounting instructions:

Sight glass tubular type must be mounted without tension by tube, vibrations and pressure pushes.

Sight glass - Tubular type

with Safety Seal-System, acc. to DIN 28121

NORIS

Bauform 25

Application:

Sight glass - Tubular type with **DIN**-flanges on both sides, to use in either horizontal or vertical pipe lines for optical control of fluids and gasses.

Operating conditions:

Connection: Flanges PN 10/16
 Pressure: up to DN 100 - 6 bar max
 DN 125 and up – 4 bar max
 Temperature: 200°C max.

Installation:

Optional

Special designs:

Protection jacket of acrylic glass
 Flanges acc. to ANSI
 Extra length

Materials:

Flanges	WN 1.4571	Steel / H II
Distance-Bars	WN 1.4571	Steel
Screws	A4-70	Steel
Glass tube	Borosilicate glass (DURAN)	
Gaskets	PTFE covered	

Ordering example:

Sight Glass - Tubular Type Bauform 25
 WN 1.4571,
 Max. 6 bar / 200°C
 DN 50, PN 16

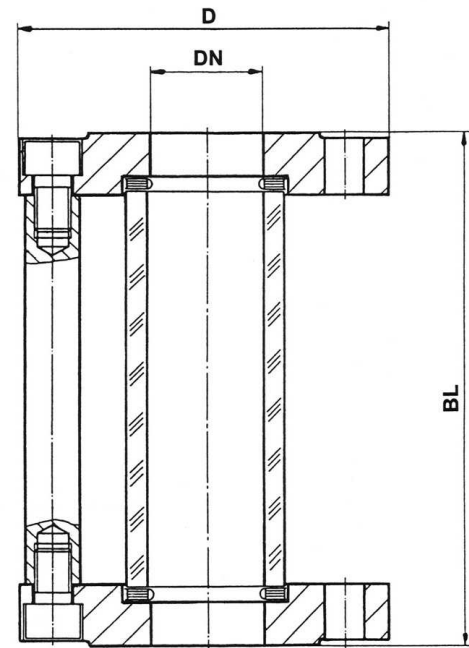

(Picture with acrylic-jacket)

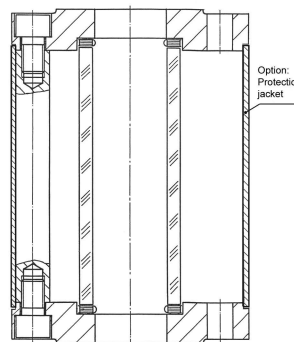

Dimensions:

DN	D	BL
25	115	160
40	150	200
50	165	230
80	200	310
100	220	350
125	250	400
150	285	480

Mounting instructions:

Sight glass tubular type must be mounted without tension by tube, vibrations and pressure pushes.

Modification reserved

Sight glass - Tubular type

with Safety Seal-System, acc. to DIN 28121

NORIS

Bauform 25-A

Application:

Sight glass - Tubular type with **ANSI**-flanges on both sides, to use in either horizontal or vertical pipe lines for optical control of fluids and gasses.

Operating conditions:

Connection: ANSI-flanges 150 lbs
 Pressure: up to ANSI 2" - 6 bar max
 ANSI 5" and up - 4 bar max
 Temperature: 200°C max.

Installation:

Optional

Special designs:

Protection jacket of acrylic glass
 Extra length

Materials:

Flanges	WN 1.4571	Steel / H II
Distance-Bars	WN 1.4571	Steel
Screws	A4-70	Steel
Glass tube	Borosilicate glass (DURAN)	
Gaskets	PTFE covered	

Ordering example:

Sight Glass - Tubular Type Bauform 25-A
 WN 1.4571
 ANSI 2" 150 lbs; 6 bar max.

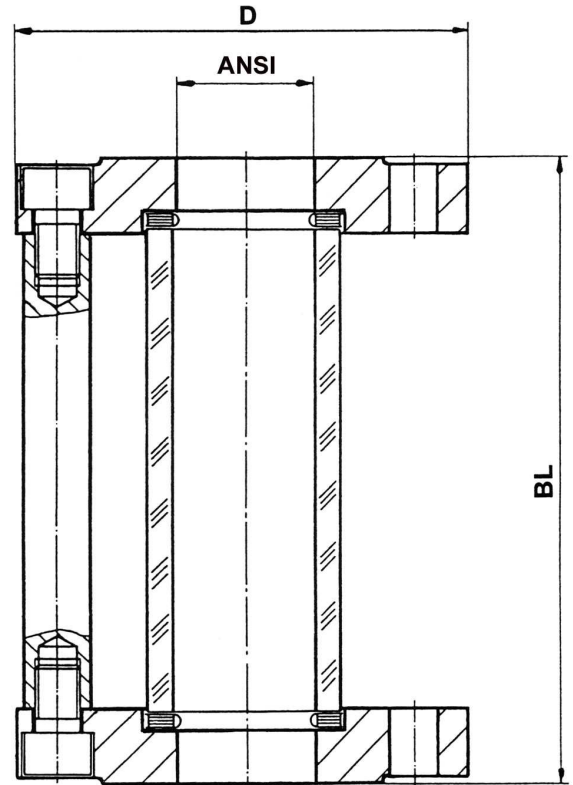

Standard design

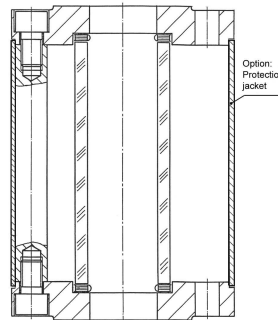

Dimensions:

ANSI	D	BL
1"	108	160
1 1/2"	127	200
2"	152	230
3"	190	310
4"	228	350
5"	254	400
6"	279	480

Mounting instructions:

Sight glass tubular type must be mounted without tension by tube, vibrations and pressure pushes.

Modification reserved

Sight Glass -Tubular Type

with Indication- and Non-Return-Ball
with Safety Seal-System (acc. to DIN 28121)

NORIS

Bauform 25-B

Application:

Sight glass - Tubular type with DIN-flanges on both sides to use in vertical pipe lines for optical control of fluids and gasses. If the fluid starts flowing, the indicatorball begins to suspense. The design of the ballseat allows the ball to work like a check valve.

Operating conditions:

Connection: Flanges PN 10/16
Pressure: 6 bar max.
Temperature: 200°C max.

Installation:

Vertical.
Take care of flow direction from bottom to top

Spezial designs:

Material Steel
Hollow-ball possible (3 bar max.)

Materials:

Flanges	WN 1.4571
Screws	A4-70
Glass tube	Borosilicate glass
Ball + Seats	PTFE
Gaskets	PTFE covered

Ordering example:

Sight Glass - Tubular Type Bauform 25-B
WN 1.4571; 6 bar / 200°C
DN 50, PN 16

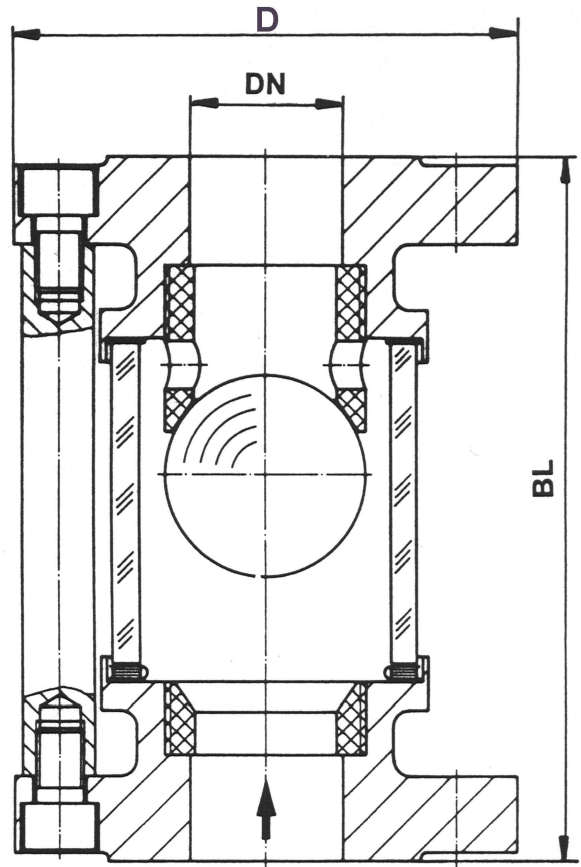

Dimensions:

DN	D	BL
25	115	160
40	150	200
50	165	230
80	200	310
100	220	350

Mounting instructions:

Sight glass tubular type must be mounted without tension by tube, vibrations and pressure pushes.

Modification reserved