

## SERIE 12

**Round autoclave doors P12-510**

References: P12-510 / P12-610 / P12-810

**Finitions :**

ON STEEL OR CARBON :

- ⊗ Manufacturing crude without coating

ON STAINLESS STEEL :

- ⊗ BURNISHING: Rolled sheets and flats, presence of tool marks, unstripped welds.
- ⊗ MICROBLES: Satin matte appearance.
- ⊗ ELECTROPOLISHING WITH Ra (μ): on request from < 1.6 to > 0.4.

STANDARDS AND SPECIFICATIONS :

**Frame :**

- ⊗ Hot rolled plate in stainless steel 1.4301 / 1.4307 or 1.4404, height 80 mm, thickness 8 mm, usable passage with tolerance of +/- 2 mm.
- ⊗ Standard finish: Microblasted.

**Wicket door :**

- ⊗ Sheet 2B of 3 mm in 510 and 610 or 5 mm in 810, in stainless steel 1.4301 / 1.4307 and 1.4404, electropolished.

**Component parts :**

- ⊗ Stainless steel 1.4301 or 1.4307.
- ⊗ Stainless steel handwheel or lever in 1.4401, 1.4404, 1.4305, 1.4301 or 1.4307 with or without bronze insert according to model to be seen with the sales department.

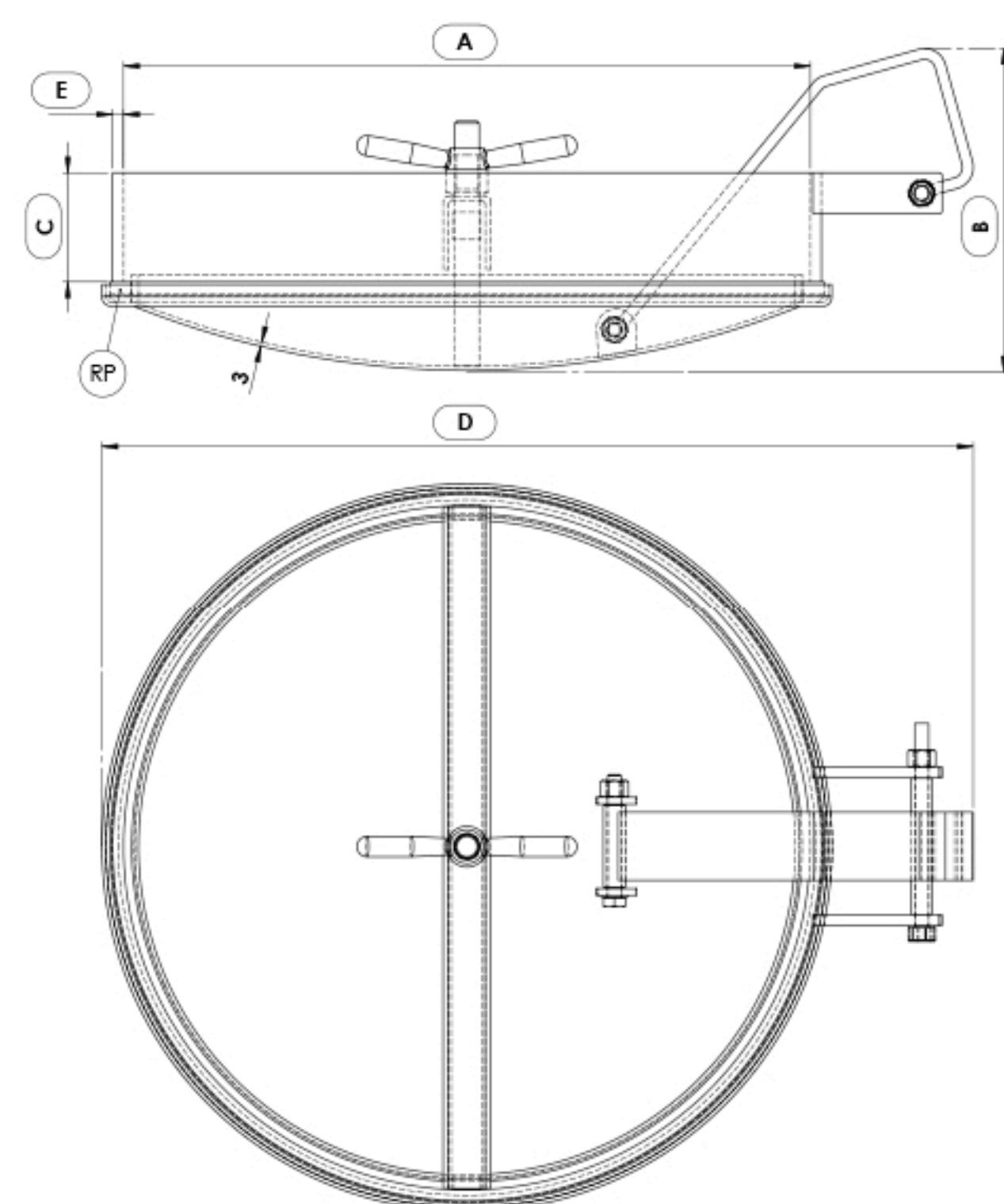
**Technical specifications**

	DN Size	Frame			Space requirement		Number of clamps	Unit Weight in kg	CALCULATION PRESSURE (non FEP gasket) CODAP IN BAR at 150° (To be limited according to the gasket material used)			Pmax Maximum operating pressure at room temperature (Bar) non-FEP seal. Door not submitted.	Vacuum Vacuum pressure Absolute value in BAR (non-FEP seal)	Joints
		A	C	E	B	D Dim hors tout			Operating pressure 150°C	Test pressure 20°C	ASME 2007 in BAR at 150° without the 'u' stamp			
P12-510	504	80	8	270	639	1	22	NA	NA		1,0	NA	sticked	
P12-610	604	80	8	270	739	1	26	NA	NA		1,0	NA	sticked	
P12-810	800	80	8	270	894	1	35	NA	NA		1,0	NA	sticked	