

Sight Glass Fittings, circular,
acc. to **DIN 28120**
to be **welded** directly to tank

NORIS

Bauform 120

Application:

For observation and lightning the inside of closed containers
(boilers, tanks, silos a.s.o)

Operating conditions:

Working pressure: 10 or 16 bar
Working temperature: 150°C or 280°C

Options:

Sight Glass wiper Bauform 190 + 195
Spray washer Bauform 198
Safety double windows Bauform 126 + 120-D
Sight glass light fittings
Lined, Type B, acc. to DIN 28120
With O-ring-sealing (for vacuum)
Special design acc. to customer

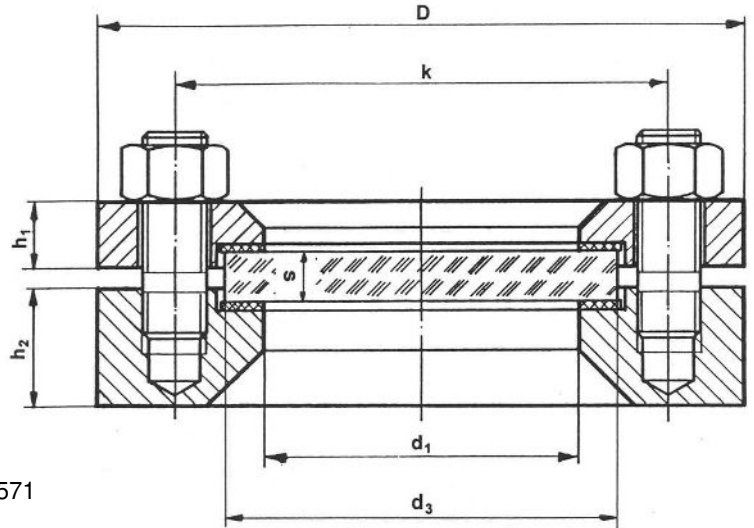

Materials:

Base- and coverflange	RSt 37-2, H II, C 22.8, 1.4541, 1.4571 or on request
Glass	Soda lime glass acc. to DIN 8902 Borosilicate glass acc. to DIN 7080
Gaskets	Kingersil or on request
Screws/Nuts	Steel 5.6 gal. / A2-70 / A4-70

Delivery includes:

Complete fitting, consisting of base and cover flange, glass plate, gaskets and screws with nuts

Certificate: (Option)

Acc. to EN 10204-2.2 or
Acc. to EN 10204-3.1

Dimensions:

DN	PN	d ₁	d ₃	s	D	k	h ₁	h ₂	Screws
25	10	48	63	10	115	85	16	25	4 x M 12
	16								
40	10	65	80	12	150	110	16	30	4 x M 16
	16								
50	10	80	100	15	165	125	16	30	4 x M 16
	16								
80	10	100	125	15	200	160	20	30	8 x M 16
	16			20					
	25								
100	10	125	150	20	220	180	22	30	8 x M 16
	16			25					
	25								
125	10	150	175	20	250	210	25	30	8 x M 16
	16			25					
	25								
150	10	175	200	25	285	240	30	36	8 x M 20
	16			30					
	30								
200	10	225	250	30	340	295	35	36	8 x M 20



Modification reserved

Screwed sight glass fitting

(screwed pipe connections similar. to DIN 11851)

NORIS

Bauform 127

Application:

Sight port for viewing into vessels, containers and pipelines. Particularly suitable for creameries, food, breweries, beverage industry, pharmaceutical- and medical technology.

Operating conditions:

Working pressure: 6 bar
 Working temperature: 220°C
 Vacuum

Options:

Light fittings
 Wiper
 Higher pressure

Materials:

Butt weld pipe end	WN 1.4404 or 1.4301
Slotted cover nut	WN 1.4301
Glass	Borosilicate glass DIN 7080 Soda lime glass DIN 8902
Gasket	Silicone / Viton / EPDM / PTFE
Protection ply	Asbestos free

Ordering example:

Screwed sight glass fitting NORIS Bauform 127
 WN 1.4301; Borosilicate glass;
 Gasket silicone
 DN 50

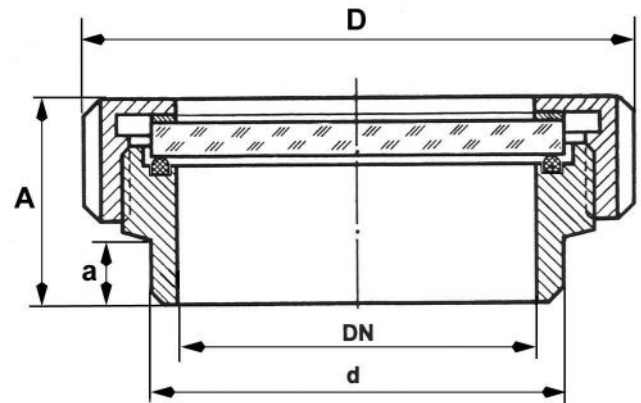
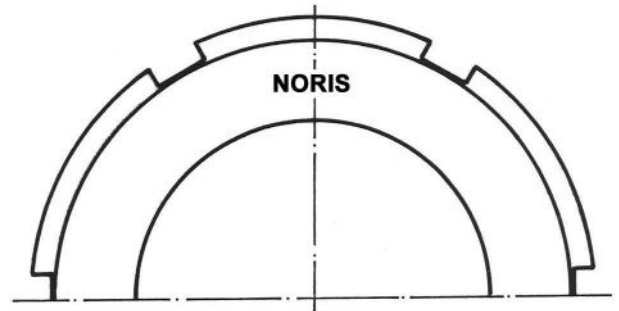

Dimensions

DN	a	A	d	D
50	18	46	55	92
65	22	49	72	112
80	23	54	87	127
100	32	65	106	148
125	20	60	132	178

Modifications reserved

Sight Glass Fittings Rectangular

to be welded directly to tank

NORIS

Bauform 220

Application:

To show surface of a liquid, for insertion into attachments to tanks, vessels and silos.

Operating conditions:

Temperature : 243°C (Saturated steam or hot water in direct contact)
 Pressure: 16 bar

Option:

are available on request

Materials:

Welding pad	WN 1.4571	WN 1.4571	RSt 37-2
Cover	WN 1.4571	RSt 37-2	RSt 37-2
Screws	A4-70	8.8 vz	8.8 vz
Glass	Borosilicate glass DIN 7081, reflex		
Gaskets	Asbestos free (or other materials)		

Mounting instruction: After welding please examine if sealing area is plane. Otherwise re-machining is necessary.

Caution: Before putting the fitting into operation, the strength of the cutout reinforcement in combination with the vessel wall should be checked in accordance with TÜV leaflet B9 (AD Merkblatt B 9)

Example for an order:

Sight Glass Fitting Rectangular Bauform 220
 Welding pad WN 1.4571; Cover RSt 37-2
 370 x 70 mm

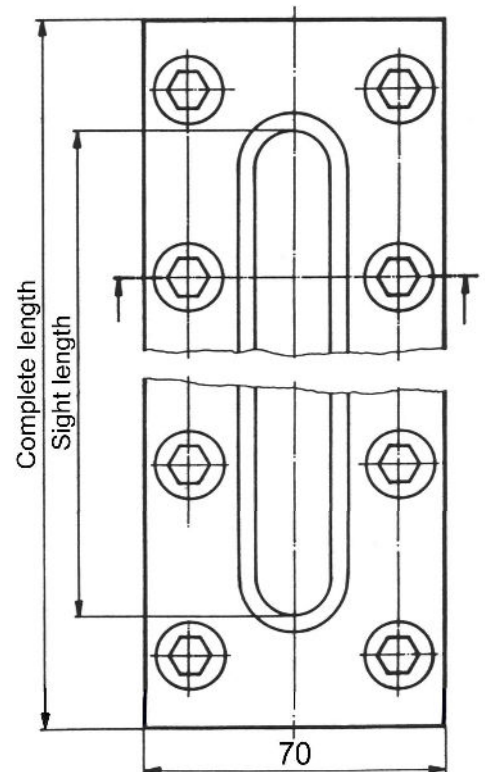
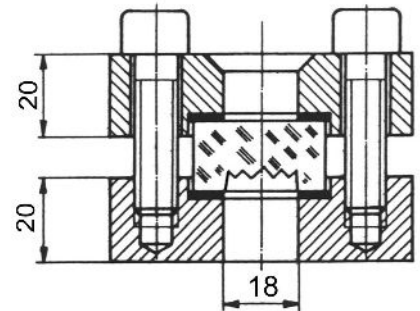
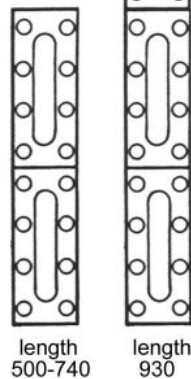

Dimensions:

Complete length*	170	220	250	310	370	500	620	740	930
Sight length	120	170	200	260	320	450	570	690	880
Sight interrupted						50	50	50	2 x 50
Number of screws	8	10	12	14	16	24	28	32	42

* By length 500 to 740mm there are 2 glasses / by length 930mm there are 3 glasses

Modification reserved

Sight Glass Fittings Obround

to be **welded** directly to tank

NORIS

Bauform 225

Application:

To show surface of a liquid, for insertion into attachment to tanks, vessels and silos.

Operating conditions:

Temperature : 100°C or 280°C
Pressure: 3 / 6 / 25 bar

Materials:

Body	WN 1.4571	RSt 37-2 / H II
Cover	WN 1.4571	RSt 37-2 / H II
Screws	A4-70	8.8 vz
Glass	Borosilicate glass acc. to DIN 7081 Soda lime glass acc. to DIN 8903	
Gaskets	Asbestos free (or other materials)	

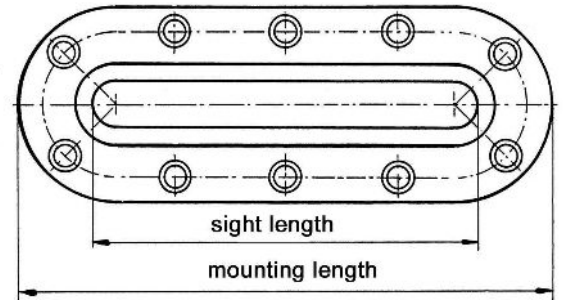
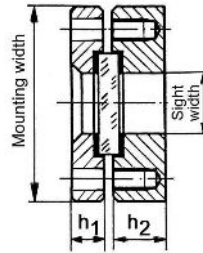

Mounting instruction:

After welding please examine if sealing area is plane. Otherwise re-machining is necessary.

Caution:

Before putting the fitting into operation, the strength of the cutout reinforcement in combination with the vessel wall should be checked in accordance with TÜV leaflet B9 (AD Merkblatt B 9)

Pressure 3 bar, Visual 50 mm

Mounting dim. Length x Width	Sight dim. Length x Width	Strength	
		h1	h2
270 x 120	200 x 50	15	25
340 x 120	270 x 50	15	25
410 x 120	340 x 50	15	25
480 x 120	410 x 50	15	25
550 x 120	480 x 50	15	25
620 x 120	550 x 50	15	25
690 x 120	620 x 50	15	25
760 x 120	690 x 50	15	25

Example for an order:

Sight glass fittings, obround Bauform 225
Body WN 1.4571
Cover RSt 37-2
Borosilicate glass – 3 bar
410 x 120 mm

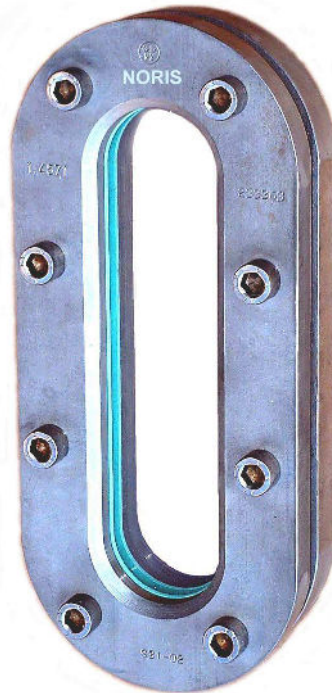

Pressure 6 bar, Visual 30 mm

Mounting dim. Length x Width	Sight dim. Length x Width	Strength	
		h1	h2
250 x 100	180 x 30	15	25
310 x 100	240 x 30	15	25
370 x 100	300 x 30	15	25
430 x 100	360 x 30	15	25
490 x 100	420 x 30	15	25
550 x 100	480 x 30	15	25
610 x 100	540 x 30	15	25
670 x 100	600 x 30	15	25

Pressure 25 bar, Visual 20 mm

Mounting dim. Length x Width	Sight dim. Length x Width	Strength	
		h1	h2
176 x 70	126 x 20	20	25
226 x 70	176 x 20	20	25
256 x 70	206 x 20	20	25
316 x 70	266 x 20	20	25
376 x 70	326 x 20	20	25
436 x 70	386 x 20	20	25
496 x 70	446 x 20	20	25
536 x 70	486 x 20	20	25

Modification reserved

Sight Flow Indicator (straight line) DIN 3237

with *flanged*-Connection acc. to **DIN - PN 16, PN 25 and PN 40**

NORIS

Bauform 880

Application:

The flow indicators are used for optical control of fluids and gases, for horizontal and vertical pipe lines.

Operating conditions:

Working pressure: 16 / 25 / 40 bar
Working temperature: 150°C or 280°C

Installation:

Optional; Take care of flow direction

Options:

with ANSI-flanges
with Butt weld ends
with Spinner or Flap
with Heating jacket
with Sight glass light - fittings

Materials:

Cast Iron GG 25 (EN-GJL-250) max 16 bar
Cast Steel GS-C 25 (1.0619 / GP240GH)
Stainless Steel WN 1.4408

Body	GG 25	GS-C 25	1.4408
Covers	GG 25 / S235JRG2	GS-C 25 / S235JRG2	1.4408 / 1.4301
Screws	4.6 / 5.6 gal.		A4-70
Glass	Borosilicate glass DIN 7080 Soda lime glass DIN 8902		
Gaskets	Graphite, (or other materials)		

Certificate: (Option)

Acc. to EN 10204 - 2.2 or 3.1

Ordering example:

Sight Flow Indicators Bauform 880,
GG 25, with borosilicate glass DIN 7080
DN 50, PN 16

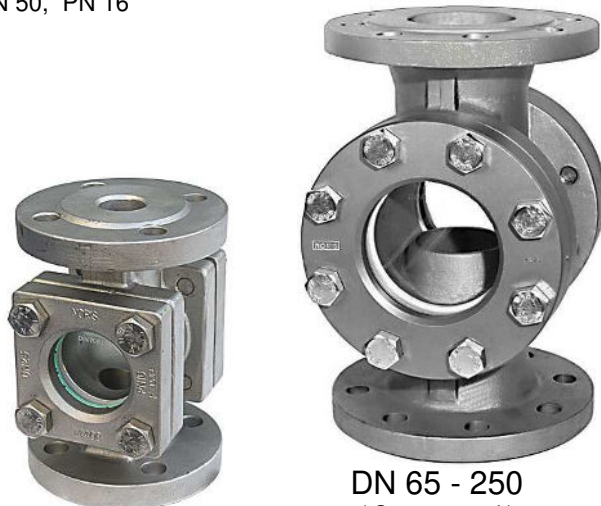
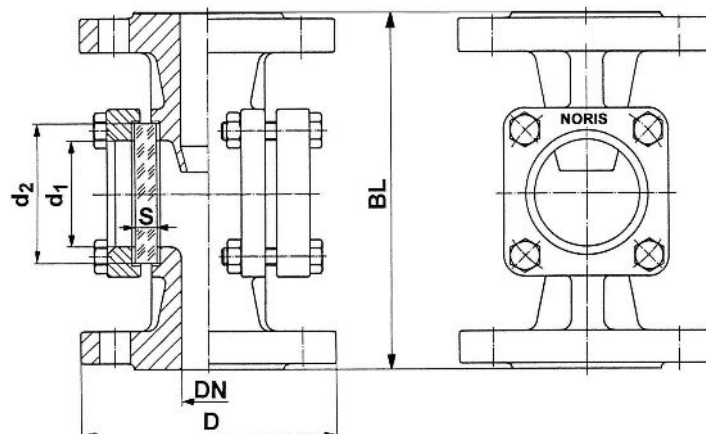

DN 15 - 50
(Covers square)

DN 65 - 250
(Covers round)

Dimensions:

DN	D	BL	d ₁	Glass plate			
				d ₂	S		
					PN 16	PN 25	PN 40
15	95	130	32	45	10	10	10
20	105	150	32	45	10	10	10
25	115	160	48	63	10	12	15
32	140	180	48	63	10	12	15
40	150	200	65	80	12	15	20
50	165	230	80	100	15	20	25
65	185	290	80	100	15	20	25
80	200	310	100	125	20	25	30
100	220(235) *	350	125	150	25	30	35
125	250(270) *	400	150	175	25	30	a.A.
150	285(300) *	480	175	200	30 **	35	a.A.
200	340(360/375) *	600	175	200	30 **	35	a.A.

* D in () acc. to PN 25 / PN 40

** 16 bar only with borosilicate glass possible

Modification reserved